

2015  
DYNASTY

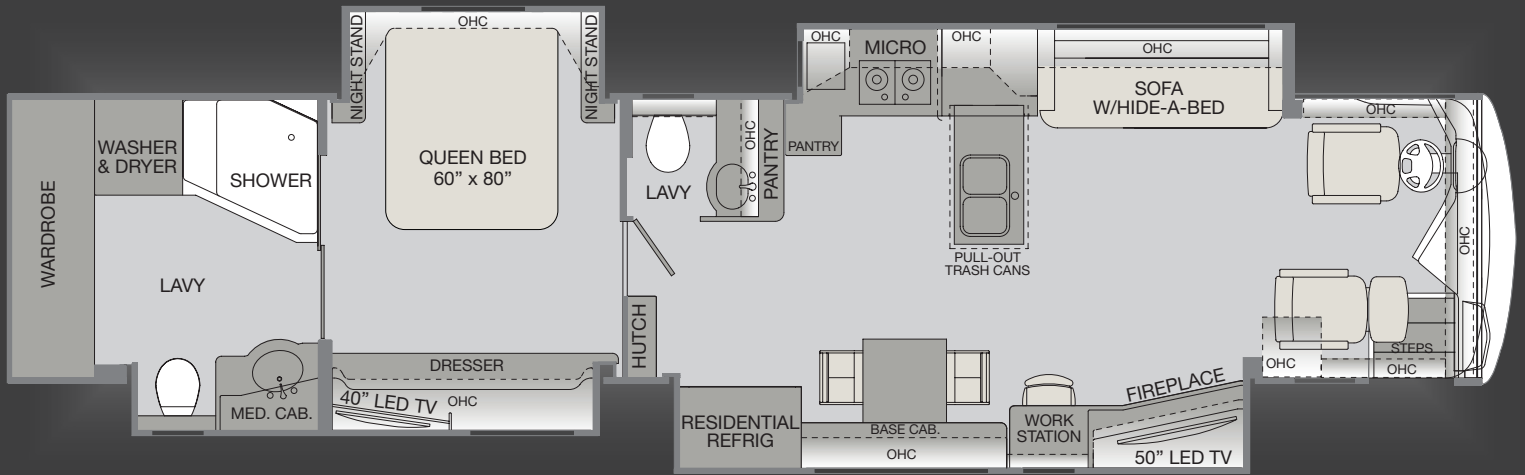

MONACO®

# 2015 DYNASTY 45 PALACE



## FURNITURE OPTIONS

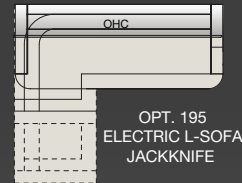
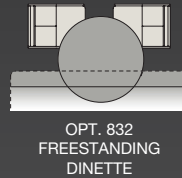

## INTERIOR DECOR



CABINETRY



CLASSIC RADIANCE

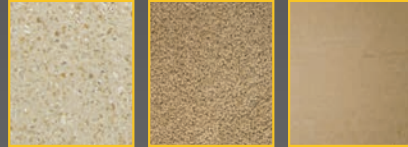

SATIN SILHOUETTE



GRAND CANYON SUNSET



GLAZED ITALIAN SIENNA



GLAZED DARK CHERRY

# 2015 DYNASTY 45 PALACE

## EXTERIOR DECOR



CLASSIC RADIANCE



GRAND CANYON SUNSET

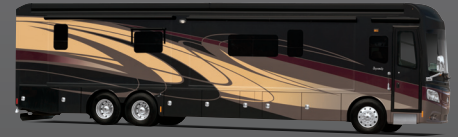

SATIN SILHOUETTE



## SURROUNDING YOU WITH THE FINEST

The 2015 Dynasty is better and more powerful than ever before. We're reclaiming the brand's legacy of luxury, quality and power. Not just a return to the powerful Cummins® engines, but a return of power to owners, as the new Monaco products are a true reflection of their input and the magnificent amenities for which Monaco was once so well known. Everywhere you look, you'll find inspired features and finishes that contribute to the hand-crafted luxury of Monaco's flagship motorhome

Visit [MonacoCoach.com](http://MonacoCoach.com) and discover the all-new 2015 Dynasty today.



## STANDARD AND OPTIONS

### INTERIOR GENERAL AMENITIES

- 12V LED Ceiling & Task Lighting
- Soft Touch Padded Ceiling w/ Decorative Trim
- Decorative Soffits w/ Crown Molding
- Fully Concealed & Adjustable Cabinet Door Hinges
- Integrated Latch Hardware in Pocket Doors
- Hardwood Window Treatments
- Interior MultiPlex Power Management System
- Lined Cabinet Interiors

- Polished Porcelain Tile Floor
- Premium Hardwood Custom Cabinetry & Moldings
- Solid-Surface Entry-Step w/LED Accent Lights & Storage
- Wood-Trimmed Fan-Tastic® Rain Sensor, Power Roof Vents w/3-Speed Fan (3)

#### OPTIONS

**OPT560** - Factory V.I.P. Delivery

**OPT693** - Custom Interior Request

### DRIVERS CONVENIENCE

- Adjustable Brake & Throttle Pedals
- Auxiliary Fog Lamps
- Auxiliary Start Switch
- Chrome, Heated Side-View Mirrors w/Remote Adjustment & Turn Signal Indicators, Side Vision Cameras Integrated Into Mirrors
- Color Camera Monitor w/One-Way Audio
- Driver & Passenger LED Reading Lights
- Dual-Dash Monitor Design
- Air Horns
- Halogen Head Lamps
- I.C.C. Light Switch
- Integrated Rand McNally® RV GPS
- Keyless Entry Door Access w/Key Fob
- Low-Profile Automotive-Style Dash w/Burlwood Accents
- Backlit Gauges & Switches
- Multiple Auxiliary 12-Volt Dash Receptacles
- Powered Windshield, Driver & Passenger Privacy Blinds & Shades

- Pressure Pro® Active Tire Pressure Monitoring System
- SGM Dash HVAC System w/Additional Defrost Blower
- Silverleaf® Chassis Monitoring System
- Sirius® Satellite Radio Ready (Subscription Required)
- Smart Wheel w/Leather & Burl Wood Trim w/Manual Tilt, Tip, Telescope
- Sony Rear-View Camera
- Intermittent Windshield Wiper System w/Wet Arm
- Villa 6-Way Power Passenger Seat w/Heat, Power Lumbar, Adjustable Arms & Electric Footrest (Ultraleather)
- Villa® 6-Way Power Driver Seat w/Heat, Power Lumbar & Adjustable Arms (Ultraleather™)
- Xite® 7" Touch Screen Dash Radio w/Handsfree Bluetooth

#### OPTIONS

**OPT190** - Memory Driver Seat

**OPT290** - Memory Steering Column

**OPT580** - Collision Warning System

### LIVING AREA

- Central Vacuum System w/Sweep-in Toe Kick
- Centralized Command Center
- Desk Workstation w/Pop-Up 110V/USB Outlet
- Electric Fireplace w/Remote, 5,200 BTU
- Hardwood Front TV Overhead Cabinetry
- Large Passenger Window

- Lighted Step Well Area w/Power Cover
- Mid-coach Sony® 50" LED TV w/Sound Bar & Subwoofer
- Power Roller Shades & Privacy Blinds
- Satellite Pre-Wire Package
- Sony® Blu-ray® DVD w/Wi-Fi

#### OPTIONS

**OPT087** - Front Overhead 40" Sony LED TV

**OPT092** - TracVision® R6 Series Satellite System

**OPT095** - Winegard® In Motion Satellite System

**OPT570** - iPad® Controller for Lights, Blinds & A/V

### GALLEY

- Adjustable Shelves Throughout
- Appliance Garage
- Countertop Decorative Edge Treatment
- Decorative Backsplash
- Dual Pull-Out Trash Receptacles
- Flush-Mount Electric 2-Burner Induction Cooktop
- French Door Residential Refrigerator w/Icemaker In Door
- High-Rise Single-Level Galley Faucet w/ Sprayer

- Polished Solid-Surface Countertop & Flush Sink Covers
- Pop-Up Appliance Valet
- Pull-Out Counter Extension
- Roller Bearing Full-Extension Drawer Guides
- Stainless Steel Under-Mount Double-Bowl Sink
- Stainless Steel Convection Microwave Oven
- Toe-Kick LED Accent Lighting

#### OPTIONS

**OPT107** - Dishwasher Drawer

### BEDROOM

- Cedar-Lined Wardrobe
- Serenity Series Memory Foam King Mattress
- Full-Length Rear Wardrobe
- Hardwood 6-Panel Doors
- Key-Actuated Hidden Safe
- Lift-Up Bed w/Under-Bed Storage
- Overhead Cabinetry Above Bed
- Polished Solid-Surface Counter & Nightstand Tops

- Power Roller Shade & Privacy Blind
- Remote Generator Start Switch
- Shoe Storage Rear Wardrobe
- Sony Blu-ray® DVD Player
- Sony 32" LED HDTV
- Stacked Washer/Dryer
- Two-Speed Ceiling Fan
- Two Nightstands Each w/ 110V & USB Outlets

#### OPTIONS

**OPT126** - Combination Washer/Dryer

**OPT129** - Washer/Dryer Ready w/Shelves

**OPT856** - King Air Mattress

### FURNITURE

- Decorative Dinette & Folding Guest Chairs
- Deep-Base Dinette Cabinet Storage Credenza
- Polished Solid-Surface Dinette Table w/Slide-Out Extension

- Villa® Ultraleather™ Sofa Bed w/Air Mattress
- Freestanding Ultraleather Desk Chair

#### OPTIONS

**OPT195** - Electric Jackknife L-Sofa w/Storage Drawer

**OPT832** - Freestanding Round Dinette Table & Chairs

**OPT878** - Captain's Desk Chair Upgrade

### BATHROOM

- Decorative Custom Tile Backsplash
- Chrome Luxury Series Faucet
- Large Glass-Door Shower Enclosure
- Large Skylight in Shower
- Manual Roller Shade & Privacy Blind
- Master Bath Under-Mount Glass Bowl Sink w/LED Accents

- Guest Bath Polished Solid-Surface Countertop & Integrated Sink
- Residential Hand-Held Shower Head
- Solid-Surface Shower Surround w/Hand-Laid Tile Inlay
- Tecma® Silence Plus 2-Button Porcelain Vacuum Flush Toilets (2)

### PLUMBING/ELECTRICAL

- AquaHot™ 450D Heating System
- Auto Generator Start
- Energy Management System (50 Amp)
- Gravity & Pressurized Fresh Water Fill
- Heat Pump on Rear AC Unit
- Heated Water & Holding Tank Compartments
- Holding Tank San-T-Flush™ System
- Inverter & Battery Monitor
- Multi-Point Water Pump Switching

- PEX Plumbing System
- Power Control System Monitor
- Roof Condensation Drains
- SensaTank™ Level Monitoring System (Interior and Exterior Monitor)
- Surge Guard™ Electrical System Protection
- Three 15.0M Low-Profile Roof Air Conditioners
- Variable-Speed On-Demand Water Pump
- Whole Coach Water Filtration System

#### OPTIONS

**OPT915** - Heated Electric Radiant Tile Floor

**OPT547** - Waste Management System

**OPT672** - Power Water Hose Reel

**OPT933** - Remote Power Cord Reel (Key Fob)



### SAFETY

- 3-Point Integrated Seat Belts at Driver & Passenger Seats
- Carbon Monoxide (CO) Detector
- Daytime Running Lights
- Deadbolt Lock on Entry Door
- Emergency Egress Window
- Fire Extinguisher
- High-Mounted Third Brake Light

- Key-Actuated Hidden Safe
- Lighted Exterior Grab Handle
- Momentary Courtesy Lighting at Entry & Passenger Area
- Side Docking Lamps
- Side Turn Signal Indicators
- Smoke Detector/Alarm

### EXTERIOR GENERAL AMMENITIES

- Battery Disconnect Switches for House & Chassis
- Brushed Stainless Kick Plate Under Entry Door
- Chrome Luggage Door Handles
- Cummins Onan® 10.0 kW Quiet Diesel Generator
- Electrical Outlets in Luggage Compartments
- Full-Width Rear Rock Guard w/Stainless Logo Panel
- Keyless Entry Touch Pad
- Large Rear Engine Access Door w/Lift Assist Struts

- LED Clearance Lights
- Maintenance-Free (8) Absorbed Glass Mat 6-Volt Batteries
- Power Bus-Style Double Entry Step
- Power Cord Reel (50 Amp)
- Power Luggage Door Locks (Select Doors) w/Remote Key Fob
- Powered Slide-Out Generator Access Tray
- Protective Front Mask
- Pure Sine Wave Inverter/Charger (2800w)
- High-Mounted Engine Air Intake
- Solar Charging Panel (95w)

#### OPTIONS

**OPT035** - Custom Exterior Paint Color Request

**OPT036** - Tray Pkg-A w/ 2-90" Power Slides

**OPT037** - Tray Pkg-B w/ 1-54" Manual, 1-36" Manual & 1-90" Power Slide

**OPT051** - Two-Piece Aluminum Rear Ladder

**OPT093** - Exterior Drop-Down TV (Sony 40" LED)

### AWNINGS/DOORS/WINDOWS

- Air Seal Dual-Latch Wide Entry Door w/Screen Door
- Dual Girard® Nova 2-stage Awnings (2) w/LED Lights, Wind Sensor & Remote
- Large Frameless Tinted Tilt-Out Windows

- Power Pilot Window
- Power Entry Door Awning
- Slide-out Topper Awnings

#### OPTIONS

**OPT271** - Additional Window Awning Pkg (Charcoal)

**OPT272** - Additional Window Awning Pkg (Linen)

### EXTERIOR BODY CONSTRUCTION

- Acoustic Absorption Material in Front, Rear & Engine Compartment
- Aluminum-Framed Wall, Roof & Floor Construction
- Full Fiberglass Front & Rear Caps
- Gel Coat Fiberglass Sidewalls w/No Wood Substrate
- 6-Layer Radius Roof w/up to 5" Foam Insulation
- 5-Layer Floor w/ 3" Foam Insulation
- Molded Fiberglass Fenders

- One-Piece Bonded Front Windshield
- One-Piece Molded Fiberglass Roof
- Premium Axalta® Sand & Buff 5-Color Full Paint w/Fades
- Reinforced Interlocking Aluminum Connections at Roof, Sidewall & Floor
- Seamless Cap to Sidewall Transitions
- Insulated Strut-Assisted Side-Hinged Luggage Doors
- Vacu-bond® Sidewall, Roof, Floor & Rear Wall

### ALL NEW ROADMASTER™ CHASSIS

- Anti-Lock Brake System (ABS)
- Automatic 4-Point Dual (Air & Hydraulic) Leveling System
- Automatic Traction Control
- Custom Tuned Sachs® Shocks (6) Dual High-Flow Fuel Fill w/Locking Doors
- Easy Access Remote Filter Location
- Engine Block Heater (1500 Watt)
- Front Air Disc Brakes & Rear Drum Brakes
- Heavy-Duty E-Coated Steel Roadmaster Bridge
- Neway® Air Suspension w/Large Volumetric Air Bags (6)

- Polished Aluminum Wheels (6) 22.5 x 9
- Protective Spray-On Undercoating
- Remote Air System Connection w/Hose & Fittings
- Side-Mounted Aluminum Radiator w/CAC
- Tag Axle w/ Air Dump Control
- Two 1900 CCA Maintenance-Free Chassis Batteries
- ZF® Independent Front Suspension w/60-Degree Steering Angle



# RETURN TO POWER

## THE 2015 MONACO DYNASTY

### WEIGHTS & MEASUREMENTS

| CHASSIS                          | ROADMASTER™ |        |
|----------------------------------|-------------|--------|
| MODELS                           | B500i       | B600i  |
| GVWR (lbs) <sup>1</sup>          | 51,000      | 51,000 |
| Front GAWR (lbs) <sup>2</sup>    | 17,000      | 17,000 |
| Rear GAWR (lbs) <sup>2</sup>     | 20,000      | 20,000 |
| Tag Axle GAWR (lbs) <sup>2</sup> | 14,000      | 14,000 |
| GCWR (lbs) <sup>3</sup>          | 66,000      | 66,000 |
| Hitch Rating (lbs) <sup>††</sup> | 15,000      | 15,000 |
| Tongue Weight (lbs) <sup>†</sup> | 1,500       | 1,500  |
| Fuel Capacity (gal)              | 150         | 150    |

#### ROADMASTER™ B500i

Model: Freightliner® SLM Series Alternator: 270 Amp Leece-Neville  
 Engine: Cummins® 12L ISX Torque: 1,645 lb-ft @ 1,200 RPM  
 w/3-Stage Engine Brake Horsepower: 500 HP  
 Transmission: Allison® 4000 MH 6-Speed w/Electronic Shift  
 Tires: 315/80R 22.5 Michelin® Radial (8)

#### ROADMASTER™ B600i

Model: Freightliner® SLM Series Alternator: 270 Amp Leece-Neville  
 Engine: Cummins® 15L ISX Torque: 1,950 lb-ft @ 1,200 RPM  
 w/3-Stage Engine Brake Horsepower: 600 HP  
 Transmission: Allison® 4000 MH 6-Speed w/Electronic Shift  
 Tires: 315/80R 22.5 Michelin® Radial (8)

### DIMENSIONS & CAPACITIES

| MODELS                                  | 45P         |
|---|-------------|
| Wheelbase (inches)                      | 302"        |
| Overall Length <sup>4</sup>             | 44' - 11.5" |
| Overall Height (with A/C)               | 12' - 11"   |
| Overall Width (maximum) <sup>5, 6</sup> | 102"        |
| Interior Height (maximum)               | 84"         |
| Interior Width (maximum)                | 96"         |
| Fresh Water Holding Tank (gal)          | 100         |
| Grey Water Holding Tank (gal)           | 60          |
| Black Water Holding Tank (gal)          | 40          |

## The all-new Roadmaster Chassis

Designed and built to deliver the very best motorhome experience, The All New Roadmaster Chassis utilizes a more rigid, advanced bridge design, engineered in tandem with Freightliner Custom Chassis. The new design features unique attributes like an electro-coated bridge structure, ZF® independent front suspension, and the industry's only volumetric air bags paired with custom tuned shocks for the responsive handling you expect from Roadmaster™.



#### ADDENDUMS

- GVWR (Gross Vehicle Weight Rating) is the maximum permissible weight of this fully loaded motorhome. The GVWR is equal to or greater than the sum of the (UUV) unloaded vehicle weight plus the (OCCC) occupant cargo-carrying capacity\*.
  - GAWR (Gross Axle Weight Rating) is the maximum permissible loaded weight a specific axle is designed to carry.
  - GCWR (Gross Combined Weight Rating) is the value specified by the motorhome manufacturer as the maximum allowable loaded weight of this motorhome with its towed vehicle. Towing and braking capacities may be different. Refer to Monaco and chassis manufacturer's manuals for complete information.
  - Length measured from front bumper to rear bumper (excludes accessories).
  - Excludes safety equipment and awnings.
  - Motorhomes feature a body width over 96" which will restrict your access to certain roads. Before purchasing, you should research any state and/or province road laws which may affect your usage.
  - Tank manufacturer's listed water capacity (WC). Actual propane capacity is 80% of water listing as required by the safety code.
- † The chassis manufacturer recommends the installation of a supplemental brake control system to activate the brakes on the vehicle or trailer you are towing. Hitch receiver ratings expressed are maximum for the hitch receiver installed and may require the purchase of additional equipment that is dependent on the weight of the towed load. Consult with hitch receiver manufacturer for further information.
- \* UUV and OCCC are found on the label containing the federal certification tag in each RV.

†† The Minimum Towable Load of this vehicle is the available weight capacity, up to GCWR, when the coach is fully loaded to maximum GVWR. However, if the coach is loaded to something less than maximum GVWR, that extra available weight capacity can be added to your Towable Load. For example, if your coach is loaded to 1000lbs less than maximum GVWR, your Towable Load increases accordingly. Do not exceed the hitch rating weight, GVWR or GCWR.

#### IMPORTANT—PLEASE READ

Product information, photography and illustrations included in this publication were as accurate as possible at the time of printing. For further product information and changes, please visit our website at [www.holidayrambler.com](http://www.holidayrambler.com) or contact your local Holiday Rambler dealer. Prices, materials, design and specifications are subject to change without notice. All weights, fuel, liquid capacities and dimensions are approximate. Holiday Rambler has designed its recreational vehicles to provide a variety of uses for customers. Each vehicle features optimal seating, sleeping, storage and fluid capacities. The user is responsible for selecting the proper combination of loads (i.e., occupants, equipment, fluids, cargo, etc.) to ensure that the vehicle's capacities are not exceeded.

#### WARRANTY INFORMATION:

Enjoy your next RV adventure with the peace of mind that comes with a 12 month/24,000 mile basic limited warranty; a 5 year/50,000 mile limited warranty on aluminum or steel frame structure; and a 3 year/50,000 mile limited warranty on the Chassis. Review your coach's limited warranty in full for complete terms and conditions.

#### SERVICE AND SUPPORT:

24/7 service and support – Toll-free 877-211-8135

©2013 Allied Recreation Group, Inc. Printed in USA.

Inventory Control Number DYN15F2, 3/14. Model Year 2015, Second Edition.



MONACO